

Date:

PROJECT DETAILS

Project Name:	Location:
---------------	-----------

CONTACT INFORMATION

Name:	Phone:
Company:	Email:

GREEN ROOF SYSTEM ACCESORIES

DRAIN BAR EDGE (10' LENGTH)

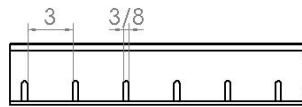
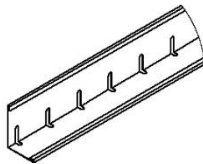
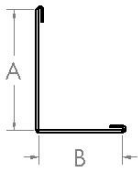

DIMENSIONS (A x B)	ALUMINUM	QUANTITY
4" x 2.875" 6" x 4.875" 8" x 4.875" 10" x 4.875"	0.063"	Units
CUSTOM _____		

CORNERS (INSIDE / OUTSIDE)

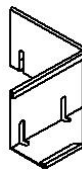
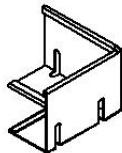
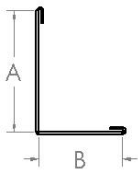

DIMENSIONS (A x B)	ALUMINUM	QUANTITY
4" x 2.875" 6" x 4.875" 8" x 4.875" 10" x 4.875"	0.063"	Units
CUSTOM _____		

Manufacturing Metal solutions with high-quality levels. If you need any advice on your project, please contact us, and we will help you to find the best solution.

- Green roofing, Landscaping and LEED projects
- Roofing, Masonry and Waterproofing
- Vents and Louvers
- Custom sheet metal parts

GREEN ROOF SYSTEM ACCESORIES

JOINTS FOR DRAIN BAR AND CORNERS

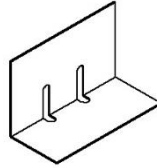
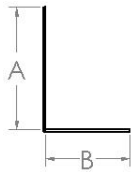

DIMENSIONS (A x B)	ALUMINUM	QUANTITY
4" x 2.875" 6" x 4.875" 8" x 4.875" 10" x 4.875"	0.063"	Units
CUSTOM _____		

*We will apply tolerances between Edging and Joints dimensions

DRAIN BOX

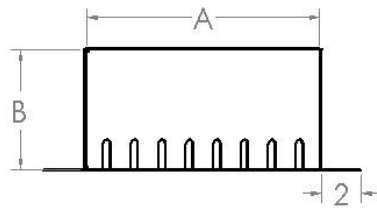
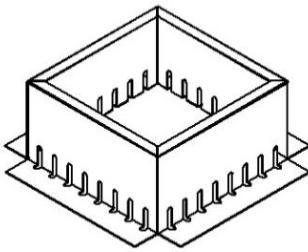

DIMENSIONS	ALUMINUM	QUANTITY
A B CUSTOM A _____ B _____	0.063"	Units

DRAIN BOX COVER

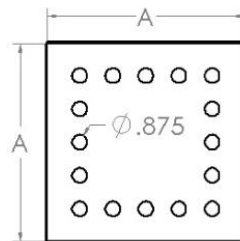
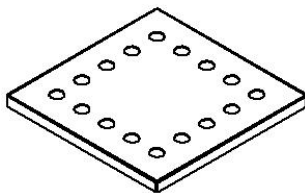

DIMENSIONS	ALUMINUM	QUANTITY
A CUSTOM A _____	0.063"	Units

ADDITIONAL COMMENTS:

Manufacturing Metal solutions with high-quality levels. If you need any advice on your project, please contact us, and we will help you to find the best solution.

- Green roofing, Landscaping and LEED projects
- Roofing, Masonry and Waterproofing
- Vents and Louvers
- Custom sheet metal parts