

# DRAIN BAR (Green roof Edging)

## Specs:

- Manufactured in .063" mill finish aluminum.
- Available in 4", 6", 8" and 10" heights. Custom dimensions and thickness of metal upon request.
- Formed in 10' lengths.
- Standard slot dimensions .375" x 2"
- Easy bent corners available for inside or outside applications.
- All parts formed with hem edge on both sides (top and bottom) for rigidity.
- Easy system assembly with quick slide unions
- Also available in stainless steel and corten steel.



Connector



Universal inside/outside corners

### Drain bar profiles

4" up to 7 7/8"

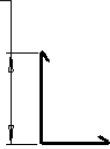

TYP profile for sizes up to 7 7/8" tall

8" and on

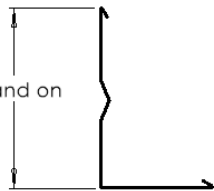

TYP profile for sizes over 8"

### Spacing of slots

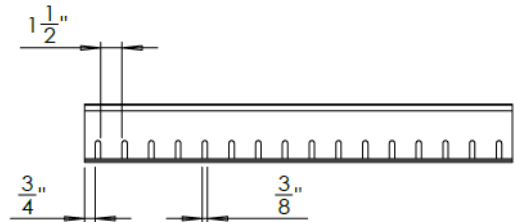

Cinnamon Metals  
7809 Loisdale Road  
Springfield, VA 22150  
703-206-8718

Drain bar (Edging)

info@cinnamonmetals.com

Date: 8/30/2023

Drawn by: JH

Approved by: CC